

USER MANUAL

INALTO?

INALTO.HOUSE

# 93L Bar Fridge

MODEL CODE/S  
IBF95BG  
IBF95W



FOR ALL AUSTRALIAN HOMES

V 3.3 | 0423

Welcome

# Congratulations on purchasing your new Bar Fridge!

**Residentia Group Pty Ltd**  
ACN. 600 546 656  
165 Barkly Avenue  
Burnley, Victoria 3121  
Australia

—  
**Applico Ltd**  
635 Great South Road  
Penrose, Auckland 1061  
New Zealand

—  
**InAlto**  
www.inalto.house  
 /inalto.house  
 /inalto.house

The InAlto brand is proudly distributed within Australia by Residentia Group Pty Ltd and within New Zealand by Applico Ltd.

Please refer to the warranty card at the rear of this manual for information regarding your product's parts and labour warranty, or visit online at:

- [www.residentia.group](http://www.residentia.group)
- [www.applico.co.nz](http://www.applico.co.nz)
- [www.inalto.house](http://www.inalto.house)

Both Residentia Group & Applico are customer obsessed and our Support Teams are there to ensure you get the most out of your appliance. Should you want to learn more about recommended usage, the various features of your appliance, and importantly taking care of the unit when cleaning, our Support Teams are here to help.

Telephone Contacts:

- AU: 1300 11 4357
- NZ: 0800 763 448

It is important that you read through the following use and care manual thoroughly to familiarise yourself with the installation and operation requirements of your appliance to ensure optimum performance.

Again, thank you for choosing an InAlto appliance and we look forward to being of service to you.

## Contents

<u>2</u>	<u>Welcome</u>
<u>4</u>	<u>Safety Instructions</u>
<u>8</u>	<u>Installation</u>
<u>10</u>	<u>Your Bar Fridge</u>
<u>11</u>	<u>Getting Started</u>
<u>12</u>	<u>Using Your Bar Fridge</u>
<u>13</u>	<u>Energy Saving Tips</u>
<u>14</u>	<u>Maintenance and Cleaning</u>
<u>16</u>	<u>FAQs &amp; Troubleshooting</u>
<u>17</u>	<u>Technical Specifications</u>
<u>18</u>	<u>Your Receipt</u>
<u>19</u>	<u>Purchase Details</u>
<u>20</u>	<u>Warranty Information</u>

---

## Customer Care

InAlto recommends the use of original spare parts.  
When contacting our customer service team on 1300 11 4357,  
please ensure that you have the following information at hand  
(which can be found on your appliances' rating plate).

- Model Number
- Serial Number

# Safety Instructions

---

## IMPORTANT SAFETY INSTRUCTIONS READ CAREFULLY AND KEEP FOR FUTURE REFERENCE

Read this manual thoroughly before first use, even if you are familiar with this type of product. The safety precautions enclosed herein reduce the risk of fire, electric shock and injury when correctly adhered to. Make sure you understand all instructions and warnings.

Keep the manual in a safe place for future reference, along with the completed warranty card and purchase receipt. If you sell or transfer ownership of this product, pass on these instructions to the new owner.

Always follow basic safety precautions and accident prevention measures when using an electrical appliance, including the following:

**IMPORTANT:** Pay particular attention to messages that contain the words **DANGER**, **WARNING** or **CAUTION**. These words are used to alert you to a potential hazard that can seriously injure you and others. The instructions will tell you how to reduce the chance of injury and let you know what can happen if the instructions are not followed.



**CAUTION**  
RISK OF FIRE

This symbol alerts you to take care as this appliance contains a flammable refrigerant (isobutane) and insulation blowing gas (cyclopentane). Do not expose it to high heat, sparks and open flames.

The refrigerant isobutane (R600a) is contained within the refrigerant circuit of the appliance, a gas with a high level of environmental compatibility, which is nevertheless flammable. During transportation and installation of the appliance, ensure that none of the components of the refrigerant circuit become damaged.

**WARNING** Do not damage the refrigerant circuit! Never use an appliance with a damaged refrigerant circuit! If the refrigerant circuit becomes damaged, avoid proximity to open fires and all types of heat and ignition sources. Thoroughly ventilate the room in which the appliance is located.

**DANGER** It is hazardous for anyone other than an authorised service person to service this appliance. In Queensland, the authorised service person **MUST** hold a Gas Work Authorisation for hydrocarbon refrigerants to carry out servicing or repairs which involve the removal of covers.

The room for installing the appliance must be at least 1m<sup>3</sup> per 8g of refrigerant. The amount and type of refrigerant in the appliance can be found in the Technical Specifications on page 17 and on the rating plate, found on the appliance.

### Usage Conditions and Restrictions

- **Domestic use only:** This appliance is intended for indoor household use only. It is not intended for commercial, industrial or outdoor use. It is not intended for use in a recreational vehicle.
- **Purpose:** Do not use this appliance for anything other than its intended purpose. Other uses are not recommended and may cause fire, electric shock or personal injury.
- **Attachments:** The use of attachments is not recommended by the appliance manufacturer and distributor as they may be hazardous.
- **Improper use:** Damage due to improper use, or repairs made by unqualified personnel will void your warranty. We assume no liability for any eventual damages caused by misuse of the product or noncompliance with these instructions.

- 
- **WARNING** Do not use mechanical devices or other means to accelerate the defrosting process, other than those recommended by the manufacturer.
  - Usage restriction: This appliance is not intended for use by persons (including children) with reduced physical, sensory or mental capabilities, or lack of experience and knowledge, unless they have been given supervision or instructions concerning use of the appliance by a person responsible for their safety.
  - Children: Supervise young children to ensure they do not play with the appliance. Never allow children to operate, play with or crawl inside the appliance.
  - **WARNING** Do not use electrical appliances inside the appliance, unless they are of the type recommended by the manufacturer.
  - Explosive or flammable substances: Do not store explosive substances such as aerosol cans with a flammable propellant in this appliance. Do not store or use petrol or any other flammable vapours and liquids in the vicinity of this or any other appliance. Do not use such substances for cleaning the appliance. The fumes can create a fire hazard or an explosion.
  - Damage: Do not use the appliance if the power cord, plug or the appliance itself is damaged. If the cord is damaged, contact the after sales support line and have the cord replaced by qualified personnel in order to avoid a hazard.
  - **WARNING** Do not damage the refrigerant circuit.
  - Do not modify: Do not attempt to alter or modify this appliance in any way.
  - Repair: Do not attempt to repair or replace any part of this appliance unless it is specifically recommended in this manual. All other servicing should be referred to a qualified technician. Contact the after sales support line for advice.
  - **WARNING** Do not locate multiple portable socket-outlets or portable power supplies at the rear of the appliance

# Safety Instructions (Cont.)

---

## Electrical Safety

- **Voltage:** Before connecting and turning on the appliance, ensure the electrical voltage and circuit frequency correspond to that indicated on the appliance rating label.
- **Earthing:** This appliance should be properly earthed for your safety. The power cord of this appliance is equipped with a three-prong plug for use in standard wall outlets to minimise the possibility of electrical shock. Do not modify the cord and/or plug provided with the appliance. Improper use of the earthed plug can result in the risk of electric shock.
- **Connection:** This appliance requires a standard 220-240 V AC 50Hz electrical outlet. Do not overload the electrical circuit.
- **Power cord:** Do not kink or damage the power cord; do not leave it exposed or dangling. Secure it at the back of the appliance so no one steps on or places anything on the cord or against it. Keep the cord out of reach of children. When moving the appliance, make sure not to damage the power cord.
- **WARNING** When positioning the appliance, ensure the supply cord is not trapped or damaged.
- **Auxiliary Items:** Do not use an inverter, adaptor or extension cord with this appliance. If the cord is too short, have a qualified electrician install an outlet near the appliance. Use of an extension cord and an inverter can negatively affect the performance of the unit.
- **Protect from moisture:** To protect against the risk of electric shock, do not immerse the unit, cord or plug in water or spray it with any other liquid. Do not connect or disconnect the electric plug when your hands are wet. Turn the power switch off before removing the plug from the socket.
- **WARNING Disconnect!** To reduce the risk of fire, electric shock or personal injury, always unplug the appliance from the socket when not in use, when moving and before cleaning or servicing. Never unplug the unit by pulling the power cord. Always grip the plug firmly and pull straight out from the power point.
- **Electrical work:** Any electrical work required for the installation of this appliance should be carried out by a qualified electrician.

Never use this appliance with a damaged refrigerant circuit! If the coolant circuit becomes damaged, avoid proximity to open fires and all types of heat sources. The room in which the appliance is located should be ventilated for a few minutes.

## Installation

**Heavy:** This appliance is heavy, take care when moving it. To avoid back or other injury, consider a two person lift or mechanical aid when installing it. Failure to do so can result in back or other injury.

**Damage:** When unpacking, check the appliance carefully for damage. If it is damaged, do not install the appliance. Contact our after sales support centre on 1300 11 43 57 for advice on examination or return of the damaged appliance.

**Protect from moisture:** Install the appliance in an indoor area protected from wind, rain, water spray or drips.

**Protect from heat:** Do not install the appliance next to an oven, grill or other source of high heat, or where it will be exposed to direct sunlight for prolonged periods of time.

**Level:** Install the appliance level in order to ensure proper operation.

## WARNING

**Ventilation:** To ensure proper ventilation, keep any ventilation openings, in the appliance enclosure or in the built-in structure, clear of obstructions. Ensure adequate air circulation around the appliance to prevent overheating.

---

### **Cleaning and Maintenance**

**Disconnect:** Unplug the appliance before cleaning or servicing. Failure to do so can result in electric shock, injury or death. Do not connect or disconnect the plug when your hands are wet.

**Flames:** Do not let open flames or ignition sources enter the appliance.

**Flammable/explosive substances:** Never clean this appliance with flammable fluids. Do not store or use volatile, flammable or explosive propellants or liquids in or close to this or any other appliance. The fumes can create a fire hazard or explosion.

**Solvents:** Do not use solvent based cleaning agents or abrasives on the interior as these may damage or discolour the surfaces of the appliances.

### **WARNING**

Do not use mechanical devices or other means to accelerate the defrosting process. Never use a sharp or metal instrument to remove frost or clean the appliance. Use a plastic scraper, if necessary.

**Service:** Do not attempt to repair, modify or replace any part of the appliance unless specifically recommended in this manual. Refer all other servicing to a qualified technician, or contact the after sales support line for advice on examination or repair of the appliance.

### **Responsible disposal**

**Note:** At the end of its working life, do not throw this appliance out with your household rubbish. Electrical and electronic products contain substances that can have a detrimental effect on the environment and human health if disposed of inappropriately. Observe any local regulations regarding the disposal of electrical consumer goods and dispose of it appropriately for recycling and recovery of the refrigerant and blowing agent. Contact your municipal authorities for advice on recycling facilities in your area.

### **WARNING**

This refrigeration appliance contains flammable refrigerants and insulation blowing gases, which must be removed before disposal. Contact your municipal authorities for any codes or regulations concerning the disposal of such materials.

# Installation

---

- **Freestanding design:** This appliance is designed to be freestanding only, and should not be recessed or built-in.
- **Floor surface:** This appliance must be properly positioned on a dry, sturdy, level surface that is strong enough to support it when it is fully loaded.
- **Ambient temperature:** The ambient temperatures must correspond to the climate class (T) indicated on the rating plate of the appliance: 16°C–38°C
- **Clearances:** Ensure that air can circulate freely around the back of the cabinet, which is necessary to cool the compressor and condenser. Allow at least 10cm clear space at the back and 30cm at the top of the unit. If you are installing your bar fridge next to a fixed wall, leave sufficient space on the hinge side to allow for the door to swing open.

**Do NOT** install/use the appliance in the following locations/situations:

- When selecting a position for your bar fridge you should make sure that the floor is level, and that the room is well ventilated with an average room temperature of between 16° and 35°.
- Always avoid locating your bar fridge near a heat source, such as a heater.
- In moist areas or areas of high humidity.
- In a recreational vehicle, or for use with an inverter.
- In direct sunlight, near heat sources, next to an open flame, cooking or heating appliance, or near any other source of high heat.
- Direct sunlight may affect the acrylic coating and heat sources may increase the unit's power consumption. For best energy efficiency install the appliance in the coolest area of the room.
- In an area with extreme cold ambient temperatures.
- In an area with excessive moisture and high humidity. Make sure it is protected from elements such as wind, rain, water spray or drips.
- In an area where petrol or other explosive and/or flammable liquids or fumes are used or stored. The fumes can create a fire hazard or explosion.

## Electrical connection

**WARNING** It must be possible to disconnect the appliance from the mains power supply; the plug must therefore be easily accessible after installation.

- Before plugging in your new bar fridge, let it stand upright for at least 1 hour. This will allow the refrigerant gases to settle into the compressor and reduce the possibility of a malfunction in the cooling system.
- The appliance must be earthed. The plug of the power supply cord is equipped with a contact for this purpose. Do not under any circumstances cut or remove the third (earth) prong from the power cord. If the plug does not fit your outlet, consult a licensed electrician for advice to have the outlet changed.
- Plug the unit into a dedicated, properly earthed wall outlet. Ensure that your outlet voltage and circuit frequency correspond to the voltage stated on the rating label.
- Secure the bar fridge's supply cord behind the unit. Do not leave it exposed or dangling to prevent injury and accidental disconnection from the power supply.
- Adjust the temperature control as described below.
- When first starting up, and after a period out of use, allow the unit to cool down for at least 2–3 hours (4 hours if starting up during warm weather in summer) before placing food in the bar fridge.



### Reversing the door

- Tools Required: Phillips head screwdriver.
- Start by ensuring the bar fridge is unplugged and empty.
- Adjust the two levelling feet to their highest position.
- To remove the door it is necessary to tilt the bar fridge backwards. Rest the fridge against something solid to prevent it from slipping whilst removing the door.
- All parts that are removed will be used when re-assembling the door hinge, so ensure they are all kept safe.
- DO NOT lay the bar fridge on its back or sides as this may damage the coolant system.
- We recommend that this is a two person procedure.

1. Remove the plastic cover from the top door hinge.
2. Unscrew the three screws from the bottom bracket and remove the hinge bracket from the opposite side. Place this to one side.
3. Slide the fridge door down approximately 15cm and remove from the top hinge, lifting the door away from the fridge.
4. Remove the two screws from the top bracket and replace the bracket using the same screws on to the opposite side.  
Note: You will need to remove the plastic cover caps from the opposite side first.
5. Slide the fridge door back onto the top hinge, ensuring that it is the correct way up. Then screw the bottom hinge bracket into place, securing the door in place.
6. Fit the plastic cover caps and ensure that the door is aligned both vertically and horizontally, before tightening the bottom hinge. Re-adjust the levelling feet.

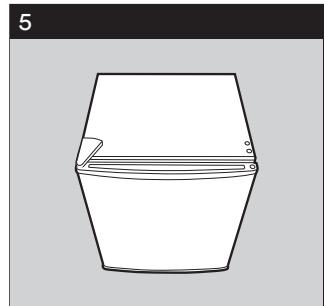
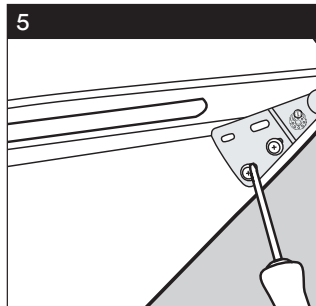
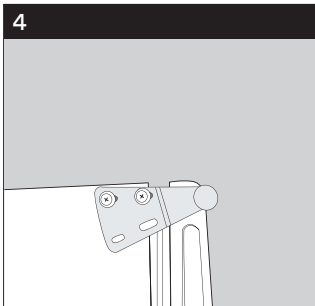
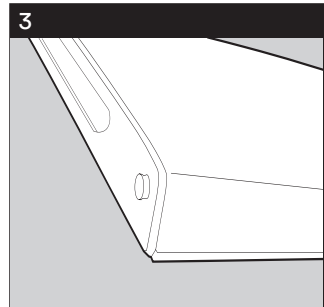
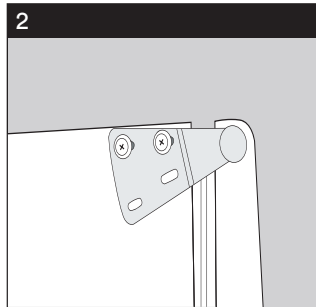
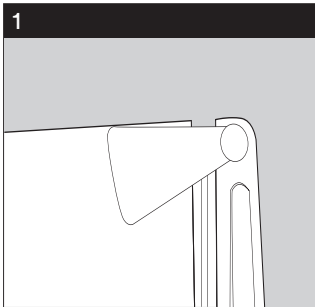

# Your Bar Fridge

IBF95BG

IBF95W



**Key:**

- 1. Chiller compartment
- 2. Defrost tray
- 3. 3 × Glass shelves
- 4. Adjustable feet

- 5. Thermostat
- 6. 3 × Door storage
- 7. Vegetable crisper
- 8. Reversible door hinge

*The images in this user manual are for demonstration purposes only. Your bar fridge may appear differently.*

# Getting Started

---

## Unpacking

- **Packaging materials:** This appliance has been packaged to protect it against transportation damage. Remove all packaging materials from around and inside the appliance and keep the original packaging carton and materials in a safe place. It will help prevent any damage if the product needs to be transported in the future, and you can use it to store the appliance when it is not in use. In the event the carton is to be disposed of, please recycle all packaging materials where possible.
- **Suffocation:** Plastic wrapping can be a suffocation hazard for babies and young children, so ensure all packaging materials are out of their reach and disposed of safely.
- **Power cord:** Unwind the power cord to its full length and inspect it for damage. Do not use the appliance if it or its cord have been damaged or are not working properly. In case of damage, contact our after sales support line for advice on examination, repair or return of the damaged product.
- **Read the manual:** Read this manual to familiarise yourself with the appliance. Pay particular attention to the Safety Instructions section.
- **Clean:** To remove any dust from transit and storage, clean the interior and exterior surfaces of the appliance with lukewarm water and a soft cloth. Dry thoroughly. **Important:** do not use harsh or abrasive detergents or powders as these will damage the finish.
- **Settling:** Before connecting the bar fridge to the power source, let it stand upright for approximately 1 hour. This will reduce the possibility of a malfunction in the cooling system from handling during transportation.

# Using Your Bar Fridge

---

## Temperature Control

- Your fridge has one control for regulating the temperature. The temperature control is located on the right hand side below the chiller compartment.
- Depending on your room's ambient temperature, you may need to adjust the temperature setting to achieve your desired temperature.
- The temperature options are as follows
  - Dial position "OFF" will power the unit off.
  - Dial position "Min" provides a cool temperature.
  - Dial position "Med" is suitable for normal operation, suitable for most situations.
  - Dial position "Max" provides the coolest temperature.

**IMPORTANT:** If the unit is unplugged, lost power, or turned off, you must wait 3 to 5 minutes before restarting the unit.

If you choose to change the thermostat setting, adjust the thermostat control by one numerical increment at a time. Allow several hours for temperature to stabilize between adjustments.

## Using for the First Time

When you install your appliance, set the thermostat knob to position "Med" for the first 24 hours, after which you can set it to the level that best suites your needs. It is the best to wait 24 hours before adding food.

**IMPORTANT:** Once the unit has started, continuous operation is recommended. Please try and avoid turning the unit off and on as this may affect the service life.

## Noise From Your Bar Fridge

- You may notice that your bar fridge makes some unusual noises from time to time. Most of these are perfectly normal, but you should be aware of them!
- These noises are caused by the circulation of the refrigerant liquid in the cooling system. This is not a fault and will not affect the performance of your unit and is common with all modern fridges.

# Energy Saving Tips

---

- The appliance should be placed in the coolest area of the room, away from heat producing appliances or heating ducts. Please avoid placement in direct sunlight.
- Let hot foods cool to room temperature before placing them in the appliance.
- Do not overload the appliance with unfrozen food as this may cause it to freeze slowly and risk food spoilage.
- Be sure to wrap foods properly and wipe containers dry before placing them in the appliance. This cuts down on frost building up inside in the unit.
- Please do not wrap items in aluminium foil, wax paper or paper towel. This materials interfere with cold air circulation, making the appliance less efficient.
- Liners interfere with cold air circulation, making the fridge less efficient.
- Organise and label food to reduce door openings and extended searches. Remove as many items as needed at one time, ensuring the unit is opened as few times as possible.

# Maintenance and Cleaning

---

## Defrosting

Defrost the freezing compartment whenever the layer of frost on the surface of the evaporator reaches 3 or 4 mm.

**Important!** Do not use boiling water because it may damage the plastic parts. In addition, never use a sharp or metallic instrument to remove frost as it may damage the cooling coils and will void the warranty. We recommend using a plastic scraper.

- When defrosting, remove all food and set the thermostat at the "OFF" position.
- Put the drip tray under the evaporator to collect melted water.
- After the frost has melted, discard the melted water and dry up the interior of refrigerator.
- The refrigerator can now be restarted by turning its thermostat to the desired setting.

**Helpful Tip:** Defrosting usually takes a few hours. Leaving the door open will help speed the process. Also, pouring warm water (not boiling) on the ice/frost will help speed melting. If you must use a scraper, please use caution—it is very easy to damage the internal compartment and void your warranty.

## Cleaning

### WARNING

Before cleaning the appliance, make sure it is switched off and disconnected from the power supply. Failure to do so can result in electric shock or serious injury.

**CAUTION:** Before using any cleaning products, please read and follow the manufacturer's instructions and warnings to avoid any damage to your Bar Fridge or personal injury.

- Upon installation of your new appliance, it is recommended that it be cleaned thoroughly.
- Dust behind the refrigerator and on the ground should be cleaned regularly to improve the cooling effect and energy saving.
- The interior of the refrigerator should be cleaned regularly to avoid odour.
- Soft towels or sponge dipped in water and non-corrosive neutral detergents are suggested for cleaning.
- The bar fridge should be cleaned with clean water and a dry cloth. Open the door for natural drying before the power is turned on.

### WARNING

Never clean the unit with an abrasive, acid, oil or solvent based cleaning agent. Never use flammable fluids or sprays for cleaning as the fumes from these substances can create a fire hazard or Explosion.

## Service, repair and spare parts

Do not attempt to alter or modify this appliance in any way, or to repair or replace any part unless it is specifically recommended in this manual. All other servicing should be referred to a qualified technician. Contact our after sales support on 1300 11 43 57 for advice.

Our after sales support centre stocks a selection of spare parts for the InAlto 93L Bar Fridge.

To enquire about purchasing a part, call us on 1300 11 43 57 or email [support@residentialgroup.com.au](mailto:support@residentialgroup.com.au)

## Power Failure

Foods can be preserved for a couple of hours even in summer in case of power failure; it is recommended to reduce the frequency of opening door and do not put fresh foods into the bar fridge.

---

#### **VACATION OR LONG TERM NON-USE**

- Remove all the food.
- Unplug the bar fridge.
- Clean the bar fridge using the instructions above.
- Leave the door open slightly to avoid possible formation of condensation, mould, or odours.
- Use extreme caution in the case of children. The unit should not be accessible to children.
- Short vacations: Leave the bar fridge operating during vacations of less than three weeks.
- Long vacations: If the bar fridge will not be used for several months, remove all food and unplug the power cord. Clean and dry the interior thoroughly. To prevent odour and mould growth, leave the door open slightly blocking it open if necessary or have the door removed.

#### **MOVING YOUR BAR FRIDGE**

- Remove all the food.
- Securely tape down all loose items inside your fridge.
- Remove the rollers to prevent damage.
- Tape the doors shut.
- Be sure the fridge stays in the upright position during transportation. Do not turn upside, horizontally place or vibrate the refrigerator, the carrying angle can not be greater than 45°.

**Note:** Continuous operation is recommended when the refrigerator is started. Please do not move the refrigerator under normal circumstances so as not to affect the refrigerator's service life.

#### **OPERATION IN CASE OF EMERGENCY**

In the event of an emergency you should:

- Switch off the bar fridge at the thermostat and then unplug the fridge at the power outlet.
- Call the Residentia Support Team on:  
1300 11 HELP (4357).
- Some minor faults can be fixed by referring to the instructions given in the Troubleshooting section.

# FAQs and Troubleshooting

<b>Fault</b>	<b>Possible Cause</b>	<b>Solution</b>
The Bar Fridge doesn't operate.	Not plugged in.	Plug the Bar Fridge in.
	The circuit breaker has tripped, or a fuse blown.	Replace any blown fuses or reset tripped circuit breakers.
	The fridge temperature is set at "OFF".	Increase the fridge temperature setting.
The compressor turns on and off frequently.	The room temperature is hotter than normal.	Try to bring the room temperature down.
	A large amount of food has been added to the fridge.	Give the Bar Fridge time to return back to your desired temperature setting.
	The door is left open too often.	Try to minimise the door being opened for sometime.
	The door is not closed completely.	Close the door completely and ensure a complete seal.
	The temperature control is not set properly.	Change the temperature control to your desired setting.
	The door gasket doesn't seal properly.	Try cleaning the door gasket seals with warm soapy water. If this still doesn't improve the seal, you may need replacement gasket seals from either a refrigeration specialist or Residentia Group.
	The fridge doesn't have the correct clearances.	Ensure your Bar Fridge has been installed in an appropriate space and has the correct clearances (as per this instruction manual).
	There has been a recent power outage.	Give the fridge a few hours to return to the desired temperature setting.
The temperature inside the Bar Fridge is too warm.	The temperature control is set too warm.	Turn the temperature control down to a cooler setting and leave for several hours for the temperature to stabilise.
	The door is kept open too long is opened too frequently.	Try to minimise the door being opened for sometime.
	The door gasket doesn't seal properly.	Try cleaning the door gasket seals with warm soapy water. If this still doesn't improve the seal, you may need replacement gasket seals from either a refrigeration specialist or Residentia Group.
	The bar fridge doesn't have the correct clearances.	Ensure your Bar Fridge has been installed in an appropriate space and has the correct clearances (as per this instruction manual).
	There has been a recent power outage.	Give the fridge a few hours to return to the desired temperature setting.
The temperature inside the Bar Fridge is too cold.	The temperature control is set too cold.	Turn the temperature control to a warmer setting and allow several hours for the temperature to stabilise.
There is a popping or cracking sound when the compressor comes on.	Metal parts undergo expansion and contraction, as in hot water pipes.	This is normal and the sound will level off or disappear as the fridge continues to run.
There is a bubbling or gurgling sound like water boiling.	The refrigerant (used to cool the fridge) is circulating throughout the system.	This is normal.
Odor	Odorous foods are not sealed. Foods have become rotten. The interior is dirty.	Odorous foods should be closely wrapped. Rotten foods should be thrown out. Ensure the interior is clean.



# Technical Specifications

---

<b>Model:</b>	IBF95BG
<b>Product Dimensions:</b>	W: 472mm, D: 450mm, H: 870mm
<b>Weight (Net/Gross):</b>	23.3kg/24.9kg
<b>Refrigerator Capacity:</b>	93L
<b>Energy Rating:</b>	3 Stars MEPS
<b>Refrigerant:</b>	R600a, 24g

---

<b>Model:</b>	IBF95W
<b>Product Dimensions:</b>	W: 472mm, D: 450mm, H: 860mm
<b>Weight (Net/Gross):</b>	21kg/22.6kg
<b>Refrigerator Capacity:</b>	93L
<b>Energy Rating:</b>	3 Stars MEPS
<b>Refrigerant:</b>	R600a, 24g

---

## Standards

This product complies with AS/NZS IEC 62552.1/2/3:2018 electrical safety, and with EN 55014-1:2006+A1:2009 A2:2011 for electromagnetic compatibility.

Attach Your Receipt Here

---



# Purchase Details

---

For your records, please record details of your purchase below and staple your receipt on the opposite page.

Your serial number can be found on the rear of your bar fridge.

## STORE DETAILS

---

STORE NAME | \_\_\_\_\_

ADDRESS | \_\_\_\_\_

TELEPHONE | \_\_\_\_\_

PURCHASE DATE | \_\_\_\_\_

## PRODUCT DETAILS

---

MODEL NO. | \_\_\_\_\_

SERIAL NO.\* | \_\_\_\_\_

# Warranty Information

---

## WARRANTY TERMS AND CONDITIONS REFRIGERATION APPLIANCES

This document sets out the terms and conditions of the product warranties for Residentia Group Appliances. It is an important document. Please keep it with your proof of purchase documents in a safe place for future reference should you require service for your Appliance.

1. **IN THIS WARRANTY**
  - (a) 'acceptable quality' as referred to in clause 10 of this warranty has the same meaning referred to in the ACL;
  - (b) 'ACL' means Trade Practices Amendment (Australian Consumer Law) Act (No.2) 2010;
  - (c) 'Appliance' means any Residentia Group product purchased by you accompanied by this document;
  - (d) 'ASR' means Residentia Group authorised service representative;
  - (e) 'Residentia Group' means Residentia Group Pty Ltd of 165 Barkly Ave, Burnley VIC 3121, ACN 600 546 656 in respect of Appliances purchased in Australia;
  - (f) 'major failure' as referred to in clause 10 of this warranty has the same meaning referred to in the ACL and includes a situation when an Appliance cannot be repaired or it is uneconomic for Residentia Group, at its discretion, to repair an Appliance during the Warranty Period;
  - (g) 'Warranty Period' means:
    - (i) where the Appliance is used for personal, domestic or household use (i.e. normal single family use) as set out in the instruction manual, the Appliance is warranted against manufacturing defects for 24 months, following the date of original purchase of the Appliance;
  - (h) 'you' means the purchaser of the Appliance not having purchased the Appliance for re-sale, and 'your' has a corresponding meaning.
2. This warranty only applies to Appliances purchased and used in Australia and is in addition to (and does not exclude, restrict, or modify in any way) any non-excludable statutory warranties in Australia.
3. During the Warranty Period Residentia Group or its ASR will, at no extra charge if your Appliance is readily accessible for service, without special equipment and subject to these terms and conditions, repair or replace any parts which it considers to be defective. Residentia Group or its ASR may use remanufactured parts to repair your Appliance. You agree that any replaced Appliances or parts become the property of Residentia Group. This warranty does not apply to light globes, batteries, seals, filters or similar perishable parts.
4. Parts and Appliances not supplied by Residentia Group are not covered by this warranty.

5. You will bear the cost of transportation, travel and delivery of the Appliance to and from Residentia Group or its ASR. If you reside outside of the service area, you will bear the cost of:
    - (a) travel of an authorised representative;
    - (b) transportation and delivery of the Appliance to and from Residentia Group or its ASR, in all instances, unless the Appliance is transported by Residentia Group or its ASR, the Appliance is transported at the owner's cost and risk while in transit to and from Residentia Group or its ASR.
  6. Proof of purchase is required before you can make a claim under this warranty.
  7. You may not make a claim under this warranty unless the defect claimed is due to faulty or defective parts or workmanship. Residentia Group is not liable in the following situations (which are not exhaustive):
    - (a) the Appliance is damaged by:
      - (i) accident
      - (ii) misuse or abuse, including failure to properly maintain or service
      - (iii) normal wear and tear
      - (iv) power surges, electrical storm damage or incorrect power supply
      - (v) incomplete or improper installation
      - (vi) incorrect, improper or inappropriate operation
      - (vii) insect or vermin infestation
      - (viii) failure to comply with any additional instructions supplied with the Appliance;
    - (b) the Appliance is modified without authority from Residentia Group in writing;
    - (c) the Appliance's serial number or warranty seal has been removed or defaced;
    - (d) the Appliance was serviced or repaired by anyone other than Residentia Group, an authorised repairer or ASR.
  8. This warranty, the contract to which it relates and the relationship between you and Residentia Group are governed by the law applicable where the Appliance was purchased.
  9. To the extent permitted by law, Residentia Group excludes all warranties and liabilities (other than as contained in this document) including liability for any loss or damage whether direct or indirect arising from your purchase, use or non use of the Appliance.
  10. For Appliances and services provided by Residentia Group in Australia, the Appliances come with a guarantee by Residentia Group that cannot be excluded under the Australian Consumer Law. You are entitled to a replacement or refund for a major failure and for compensation for any other reasonably foreseeable loss or damage. You are also entitled to have the Appliance repaired or replaced if the Appliance fails to be of acceptable quality and the failure does not amount to a major failure. The benefits to you given by this warranty are in addition to your other rights and remedies under a law in relation to the Appliances or services to which the warranty relates.
  11. At all times during the Warranty Period, Residentia Group shall, at its discretion, determine whether repair, replacement or refund will apply if an Appliance has a valid warranty claim applicable to it.
  12. Missing parts are not covered by warranty. Residentia Group reserves the right to assess each request for missing parts in a case by case basis. Any parts that are not reported missing in the first week after purchase will not provide free of charge.
  13. To enquire about claiming under this warranty, please follow these steps:
    - (a) carefully check the operating instructions, user manual and the terms of this warranty;
    - (b) have the model and serial number of the Appliance available;
    - (c) have the proof of purchase (e.g. an invoice) available;
    - (d) telephone the numbers shown below.
  14. You accept that if you make a warranty claim, Residentia Group and its ASR may exchange information in relation to you to enable Residentia Group to meet its obligations under this warranty.
- IMPORTANT**  
Before calling for service, please ensure that the steps in point 13 have been followed.
- CONTACT SERVICE**  
→ Please call 1300 11 HELP (4357)

---

**The Australian Consumer Law requires the inclusion of the following statement with this warranty:**  
Our goods come with guarantees that cannot be excluded under the Australian Consumer Law. You are entitled to a replacement or refund for a major failure and for compensation for any other reasonably foreseeable loss or damage. You are also entitled to have the goods repaired or replaced if the goods fail to be of acceptable quality and the failure does not amount to a major failure.

THIS PAGE IS INTENTIONALLY LEFT BLANK

# Warranty Information (Cont.)

## NEW ZEALAND WARRANTY TERMS & CONDITIONS REFRIGERATION APPLIANCES

To help care for your investment, be sure to register your appliance online. Registration will help you if you need to arrange service in the future, and serves as a record of your purchase – including critical information like model number and serial number – that you can refer to at any time.

Simply visit the below website, or ask your retailer for help: [www.inalto.co.nz/register](http://www.inalto.co.nz/register)

### WARRANTY:

These products are covered by a warranty for a period of 12 months from the date of purchase, subject to the following conditions\*. The warranty covers rectification free of charge of any fault arising from defective materials or components, or faulty workmanship or assembly.

\* The conditions above mentioned are:

1. That the purchaser carefully follows all instructions packed with the product;
2. That the purchaser and/or installer carefully follows the installation instructions provided and complies with electrical wiring regulations, gas and/or plumbing codes;
3. That the purchaser carefully follows instructions provided in the owner's handbook relating to the proper use and care of the product and does not use the product for any purpose other than the domestic use for which it has been designed;
4. Commercial use of the product for professional or industrial purposes will void this warranty.;
5. That the product was purchased and installed in New Zealand;
6. That this warranty does not extend to:
  - a) optional glass lids for hobs apart from claims which relate to mechanical or physical damage thereof at the date of purchase;
  - b) 'consumable' parts such as light bulbs or filters;
  - c) damage to ceramic glass caused by liquid or solid spill-overs, lack of maintenance, or impact;
  - d) damage to surface coatings caused by cleaning or maintenance using products not recommended by the owner's handbook;
  - e) defects caused by normal wear and tear, accident, negligence, alteration, misuse or incorrect installations;
  - f) a product dismantled, repaired or serviced by any serviceman other than an authorised service agent;
  - g) a product not in possession of the original purchaser;

- h) damage caused by power outages or surges
- i) damage caused by pests (eg. rats, cockroaches etc.)

7. That if the product is a freestanding microwave oven or small appliance it must be returned to the dealer/retailer for servicing. These products, unless stated otherwise, have a 12 month warranty from original date of purchase with 24 months on the microwave magnetron; Waste disposers have a 12 month warranty.
8. The provision of service under this warranty is limited by a 25km boundary from the retailer where the product was purchased except for microwaves. Such travelling outside of these limits will incur commercial cost to be paid by you, regulated by the number of kilometres travelled beyond the 25km limit (50km return trip). Microwaves are to be delivered to the nearest authorised service agent by the customer.

Please refer to your user manual for any further conditions that may apply to your specific model.

Nothing herein contained shall be construed in any way as excluding or limiting your rights under the Consumer Guarantees Acts 1993.

For Service please visit [www.applico.co.nz/service](http://www.applico.co.nz/service) or contact the dealer/retailer from whom you purchased the product from or call the 0800 number listed below. If you are unable to establish the date of purchase, or the fault is not covered by this warranty, or if the product is found to be in working order, you will be required to bear all service call charges.

Registration of this warranty constitutes acceptance of the terms and conditions of this warranty.

Should you require any assistance, please call Customer Services on 0800 763 448.

Distributed by Applico Ltd.  
[www.applico.co.nz](http://www.applico.co.nz)  
July 2019

After registering your appliance online, we recommend you fill out the below information for your reference and keep this warranty card in a safe place.

**THIS WARRANTY IS VALID IN NEW ZEALAND ONLY.**

DESIGNED IN MELBOURNE

INALTO?

FOR ALL AUSTRALIAN HOMES

—  
[WWW.INALTO.HOUSE](http://WWW.INALTO.HOUSE)  
—



E2447